

## Handling System for Rack Type Automatic Sorting Table, Dishwashing Driven with 5 Baskets - Right to Left, 2640mm

ITEM # \_\_\_\_\_

MODEL # \_\_\_\_\_

NAME # \_\_\_\_\_

SIS # \_\_\_\_\_

AIA # \_\_\_\_\_

**865467 (HSDDS5RL)**Automatic sorting table,  
dishwasher driven, 5 baskets,  
Right>Left, 2940 mm

### Main Features

- "Key holes" and "snap on" system reduces the number of screws needed for fast and easy installation.
- Designed to transport 500x500 mm dishwashing baskets.
- Stacking tables for 7 and 8 baskets on request.
- Optional extras: basin wash nozzles for cleaning the basin.
- Driven by the dishwasher.

### Construction

- All surfaces smooth with polished finish.
- Thick welded flanges for sturdy connection between the units.
- Sloping bottom of the table grants a smooth and rapid drainage.
- Stainless steel strainer baskets easy to remove.
- Rack-guides inclined towards the basin.
- Double filter strainer installed on both sides allow the access from both directions.
- Double stainless steel strainer basket for easy operation.
- Constructed in AISI 304 stainless steel with square 40x40mm tubular construction feet and legs.

### Optional Accessories

- Pre-rinse unit (thermostatic mixer and shower) to be mounted on overshef PNC 863136 ☐
- Additional waste rack for dishwasher driven and automatic sorting table PNC 863173 ☐
- Soaking basin for cutlery rack including lifting device for dishwasher driven sorting table PNC 863230 ☐
- Automatic basin wash with timer for 5-basket sorting table PNC 863231 ☐
- Emergency stop kit for Rack Type Dishwasher PNC 865162 ☐
- Basket support for vertical stacking of baskets (to be used with overshef) PNC 865208 ☐
- Pre-rinse unit (mixer and shower) PNC 865209 ☐
- Double overshef for 5-basket sorting table, 2630 mm PNC 865427 ☐
- Overshef for 5-basket sorting table, 2630 mm PNC 865431 ☐
- Tray slide for 5-basket sorting table, 2640 mm PNC 865435 ☐
- Tray slide fixing brackets (3pcs) PNC 865437 ☐
- Grid undershef for 5-basket sorting table PNC 865440 ☐
- Pre-wash spray unit, 1500 mm PNC 865443 ☐
- Tray slide for sorting table, 500 mm PNC 865444 ☐
- Tray slide with waste hole and rubber ring, 500 mm PNC 865445 ☐
- Dish scraper PNC 865447 ☐
- Water heating kit for wash basin PNC 865449 ☐
- Foldable tray slide for 5-basket sorting table, 2640 mm PNC 865456 ☐

APPROVAL: \_\_\_\_\_

- Retractable pre-rinse unit with fixed thermostatic water mixer, hose length, 14mm PNC 865460 ☐
- Brackets to support baskets under the sorting table PNC 865478 ☐

**Front**

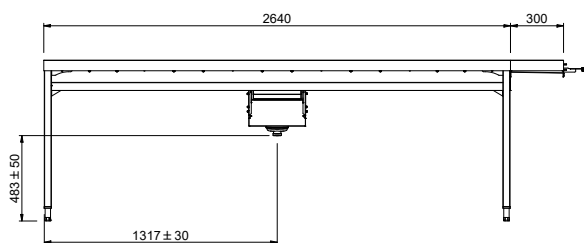

**Side**

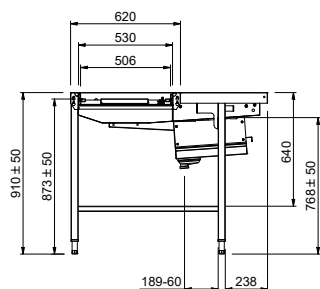

Factory mounted waste rack

**D** = Drain

**Top**

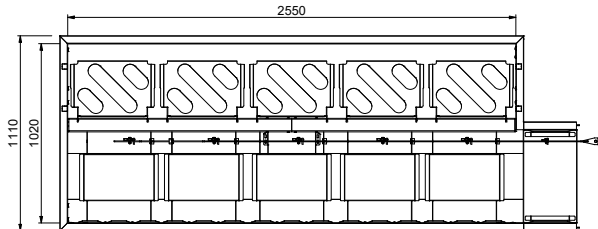

**Key Information:**

External dimensions, Width:

**865467 (HSDDS5RL)** 2940 mm

External dimensions, Depth: 1110 mm

External dimensions, Height: 910 mm

Net weight: 64 kg

Height adjustment: 50/50 mm

Basket movement: Right to left

Position to dishwasher: Loading

Basin material: Stainless Steel AISI 304 - EN 1.4301

